

GOOGLE DRIVEN	SURVEYED
Y	N

**TMO Highways**

Rookery Farm, Grays Lane  
 Pulham Market, Diss, Norfolk IP21 4XQ  
 Tel: 01379 676462

TMO-PL-009rev12 | Review due - 1/12/21

**Main Diversion**  
 HIGH STREET, CHURCH STREET  
 and vice versa.

**Closure details:**  
 On NEW ROAD, 177m  
 East from its junction with  
 CHURCH STREET, for  
 30m on the same direction.

**Customer Details:**

**Cadent**

Customer Ref: 300770669  
 Agent: RYAN DOLMAN

**Drawing Details:**  
 TM Type: ROAD CLOSURE  
 Location: 106 NEW ROAD,  
 HASLINGFIELD CB23 1LP

**Drawn By/Revised By**

Drawn by	CID	Revised by	Revision number	00
Date	18/08/21	Date	-	

Scale: N/A @ A4

Planner: S.CID  
 Email: sidonio.cid@tmohighways.co.uk

**PLEASE NOTE :**

- All Traffic Management to comply with current chapter 8 and Safety at Street Works and RoadWork's (A code of practice).
- All road markings and signage to conform to the Traffic Signs Regulations and General Directions 2002.
- All permanent traffic lights heads will be switched off and bagged at all times that temp signals are in operation, with authorisation from the appropriate authority.
- Countdown Signage spacing not shown to scale.

**Drawing checked Via Email by; AR**

This Drawing has been produced for the specific client and project as defined in drawing and customer details and is not intended for any other purpose.

**Key**

- Sign Diagram
- Advances Location
- Road Closure Location
- Access Only
- Diversion Route
- Sign To Be On A Frame

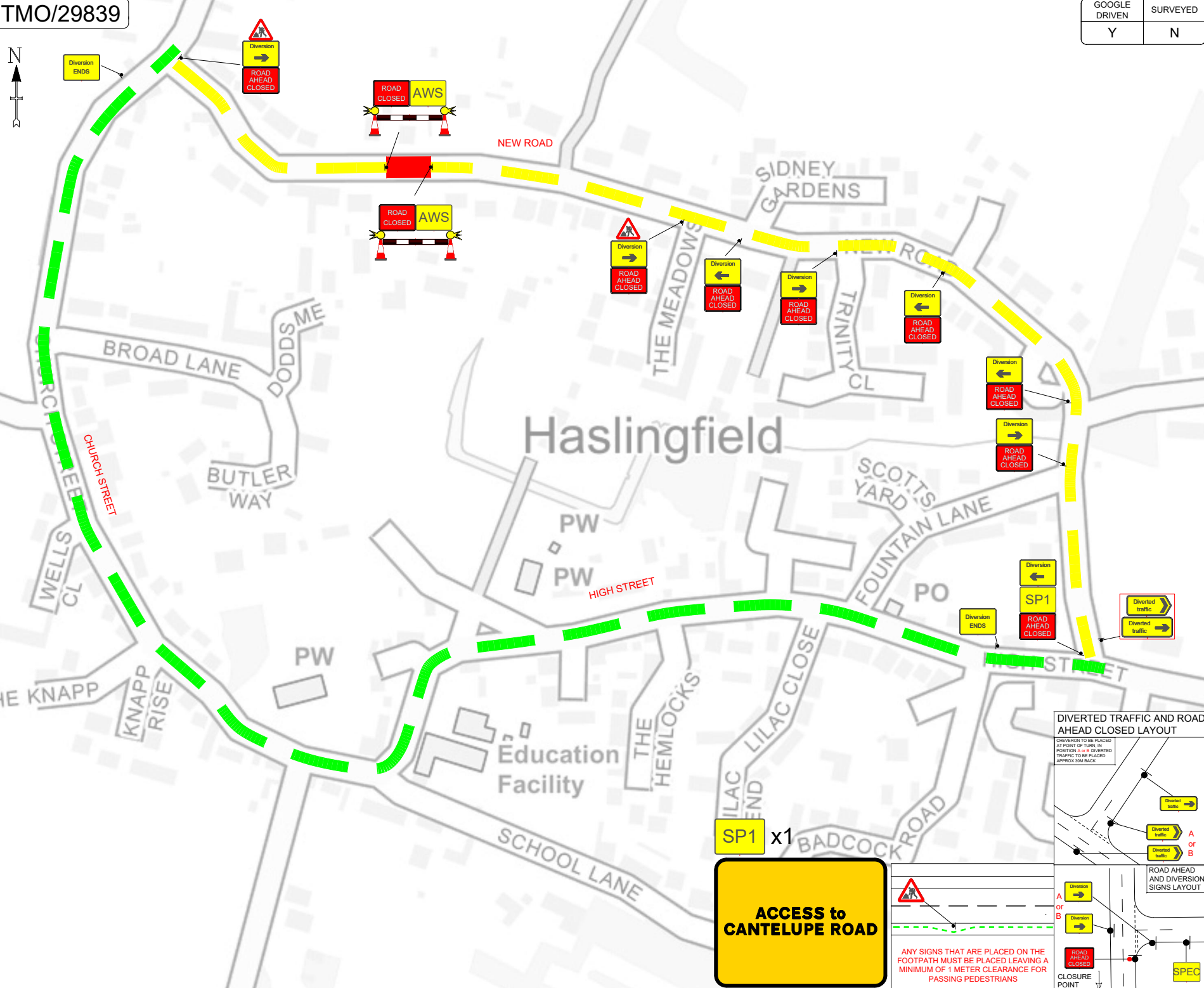

**ACCESS to CANTELUPE ROAD**

